

L6T

- Aluminum-Alloy IP65 single point load cell
- Colourless anodized
- Suitable for single or double load cell structured platform scales
- Max platform size 600mmx600mm

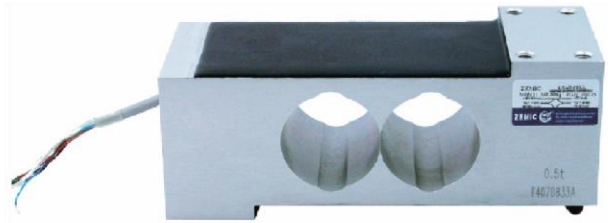

Features

- Capacities: 5kg~1000kg
- High accuracy
- NTEP Cert. No.: 12-006
- OIML Cert. No.: R/60/2000-DE1-10.11



OIML test certificate no. D09-10.23
C of C no R60/2000-DE1-10.11

NTEP Certificate no. 12-006

Specifications		
Capacity	kg	50/75/100/150/200/250/300/500/635/1000
Accuracy		C3
Maximum Number of Verification Intervals	Nmax	3000
Minimum Number of Verification Intervals	Vmin	E _{max} /7000
Output Sensitivity	(mV/V)	2.0±0.2
Input Resistance	(Ω)	406±6
Output Resistance	(Ω)	350±3
Insulation Resistance	(MΩ)	≥5000 (50VDC)
Zero Balance	(%FS)	2
Temperature, Compensated	(°C)	-10~+40
Temperature, Operating	(°C)	-35~+65
Excitation, Recommended	(V)	5~12 (DC)
Excitation, Max	(V)	18 (DC)
Safe Overload	(%FS)	120
Ultimate Overload	(%FS)	150

Dimensions in mm (in)

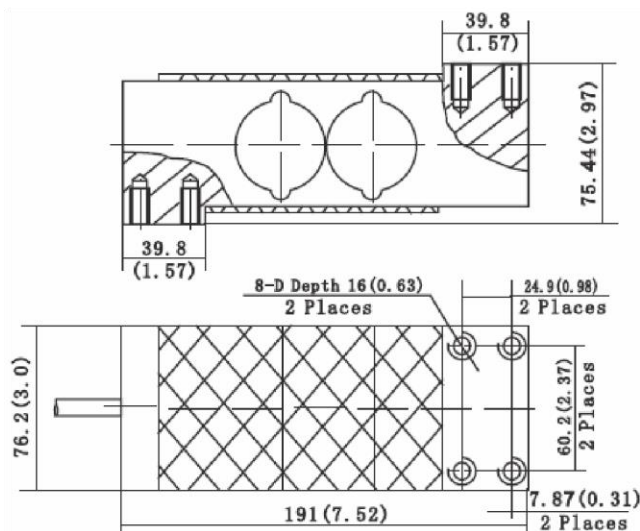

Wiring

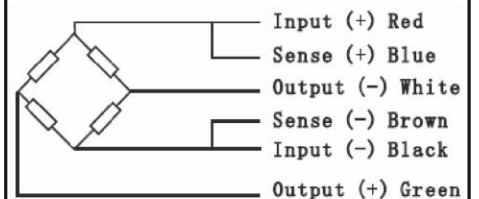

- Shielded, 6 conductor cable
- Cable diameter: 0.19in
- Standard cable length: 3m
- Shield not connected to element
- Cable jacket in PVC

C A M B R I D G E

ZEMIC **LOAD CELLS**

<u>MODEL</u>	<u>DESCRIPTION</u>	<u>CAPACITY</u>	<u>LIST</u>
L6T-XX- 3YB6	LARGE ENVELOPE SINGLE POINT LOAD CELL	50 KG	\$ 270.
		75 KG	\$ 270.
		100 KG	\$ 270.
		150 KG	\$ 270.
		200 KG	\$ 270.
		250 KG	\$ 270.
		300 KG	\$ 270.
		500 KG	\$ 270.
		635 KG	\$ 270.
		1000 KG	\$ 270.

INTERCHANGE WITH:

TEDEA HUNTLEIGH MODEL: 1250
REVERE TRANSDUCERS MODEL: 652
CAS MODEL: BCM
SENSORTRONICS MODEL: 60060
CELTRON MODEL: LOC-ALE
CN CELLS: PA6341

F.O.B.: HONEY BROOK, PA

PRICES EFFECTIVE: 01/01/18

PRICES SUBJECT TO CHANGE WITHOUT NOTICE