

L6T

- Aluminum-Alloy IP65 single point load cell
- Colourless anodized
- Suitable for single or double load cell structured platform scales
- Max platform size 600mmx600mm

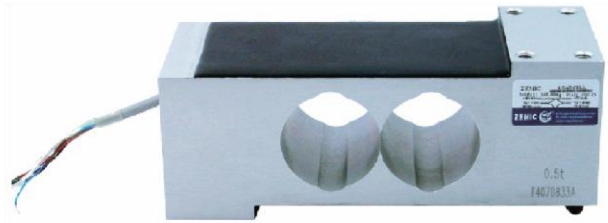

Features

- Capacities: 5kg~1000kg
- High accuracy
- NTEP Cert. No.: 12-006
- OIML Cert. No.: R/60/2000-DE1-10.11



OIML test certificate no. D09-10.23
C of C no R60/2000-DE1-10.11

NTEP Certificate no. 12-006

| Specifications | | |
|--|--------|--|
| Capacity | kg | 50/75/100/150/200/250/300/500/635/1000 |
| Accuracy | | C3 |
| Maximum Number of Verification Intervals | Nmax | 3000 |
| Minimum Number of Verification Intervals | Vmin | E _{max} /7000 |
| Output Sensitivity | (mV/V) | 2.0±0.2 |
| Input Resistance | (Ω) | 406±6 |
| Output Resistance | (Ω) | 350±3 |
| Insulation Resistance | (MΩ) | ≥5000 (50VDC) |
| Zero Balance | (%FS) | 2 |
| Temperature, Compensated | (°C) | -10~+40 |
| Temperature, Operating | (°C) | -35~+65 |
| Excitation, Recommended | (V) | 5~12 (DC) |
| Excitation, Max | (V) | 18 (DC) |
| Safe Overload | (%FS) | 120 |
| Ultimate Overload | (%FS) | 150 |

Dimensions in mm (in)

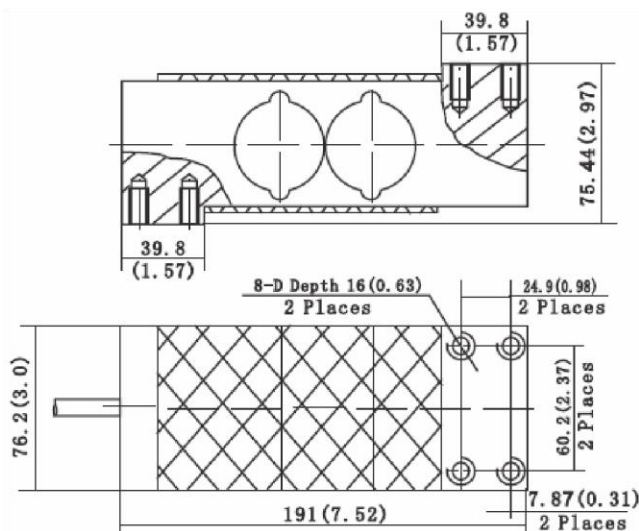

Wiring

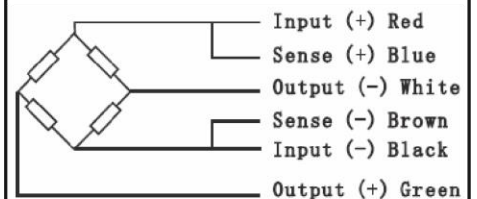

- Shielded, 6 conductor cable
- Cable diameter: 0.19in
- Standard cable length: 3m
- Shield not connected to element
- Cable jacket in PVC

C A M B R I D G E

ZEMIC **LOAD CELLS**

| <u>MODEL</u> | <u>DESCRIPTION</u> | <u>CAPACITY</u> | <u>LIST</u> |
|-------------------------|--|------------------------|--------------------|
| L6T-XX- 3YB6 | LARGE ENVELOPE SINGLE POINT LOAD CELL | 50 KG | \$ 250. |
| | | 75 KG | \$ 250. |
| | | 100 KG | \$ 250. |
| | | 150 KG | \$ 250. |
| | | 200 KG | \$ 250. |
| | | 250 KG | \$ 250. |
| | | 300 KG | \$ 250. |
| | | 500 KG | \$ 250. |
| | | 635 KG | \$ 250. |
| | | 1000 KG | \$ 250. |

INTERCHANGE WITH:

TEDEA HUNTLEIGH MODEL: 1250
REVERE TRANSDUCERS MODEL: 652
CAS MODEL: BCM
SENSORTRONICS MODEL: 60060
CELTRON MODEL: LOC-ALE
CN CELLS: PA6341

F.O.B.: HONEY BROOK, PA

PRICES EFFECTIVE: 01/01/17

PRICES SUBJECT TO CHANGE WITHOUT NOTICE