

L6N



- Aluminium-alloy IP65 single point load cell
- Colourless anodized
- Suitable for single or double load cell structured platform scales
- Maximum platform size: 15.7inx15.7in

Features

- Capacities: 3kg-100kg
- Max. platform size: 15.7inx15.7in
- PTB approval No.: D09-06.11
- High Accuracy
- OIML Cert. No.: R60-2000-CN1-06.04
- NTEP Cert. No.: CC11-055



OIML test certificate no. D09-06.11 Revision 1
C of C no R60/2000-CN1-06.04

NTEP Certificate no. 11-055

Specifications		
Capacity	kg	3/5/8/10/15/20/30/50/75/100
Accuracy		C3
Maximum Number of Verification Intervals	Nmax	3000
Minimum Number of Verification Intervals	Vmin	Emax/7000
Output Sensitivity	(mV/V)	2.0±0.2
Input Resistance	(Ω)	406 ±6
Output Resistance	(Ω)	350 ±3
Insulation Resistance	(MΩ)	≥5000 (50VDC)
Zero Balance	(%FS)	2
Temperature, Compensated	(°C)	-10~+40
Temperature, Operating	(°C)	-35~+65
Excitation, Recommended	(V)	5~12 (DC)
Excitation, Max	(V)	18 (DC)
Safe Overload	(%FS)	120
Ultimate Overload	(%FS)	300
Corner Correction		0.02% load of value/3.9in

Cross Reference	
Manufacturer	Model
Revere	642
HBM	SP4
Tedea	1042
Celtron	MT1041
Rice Lake	RL1042

Dimensions in mm (in)

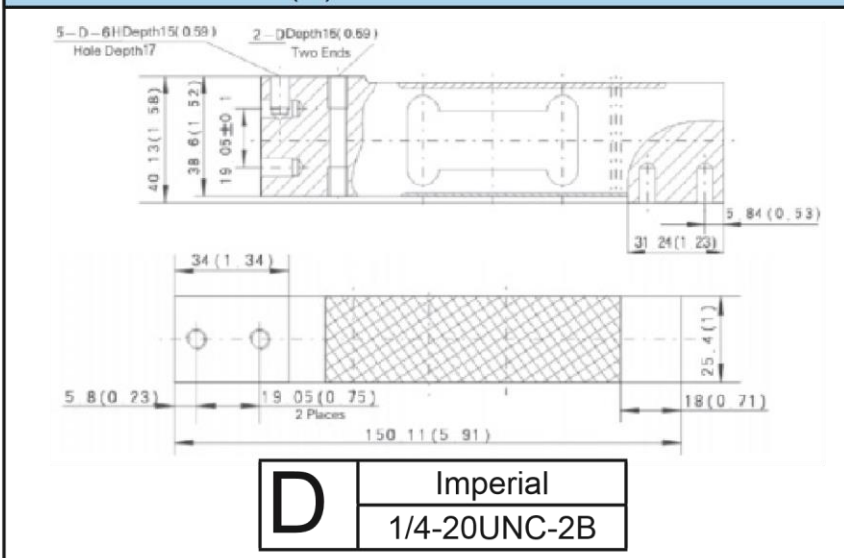

Wiring

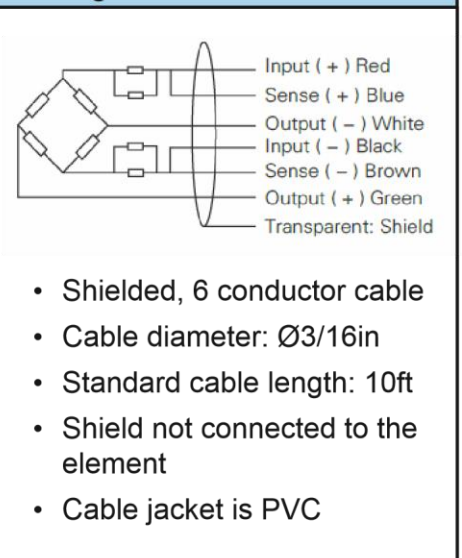

C A M B R I D G E

ZEMIC **LOAD CELLS**

<u>MODEL</u>	<u>DESCRIPTION</u>	<u>CAPACITY</u>	<u>LIST</u>
L6N-XX- 3YB6	SMALL ENVELOPE SINGLE POINT LOAD CELL	3 KG	\$ 150.
		5 KG	\$ 150.
		8 KG	\$ 150.
		10 KG	\$ 150.
		15 KG	\$ 150.
		20 KG	\$ 150.
		30 KG	\$ 150.
		50 KG	\$ 150.
		75 KG	\$ 150.
		100 KG	\$ 150.

INTERCHANGE WITH:

TEDEA HUNTLEIGH MODEL: 1040
REVERE TRANSDUCERS MODEL: 642
CAS MODEL: BCA
CELTRON TECHNOLOGY MODEL: LOC-ASE
CN CELLS: PA6340

F.O.B.: HONEY BROOK, PA

PRICES EFFECTIVE: 01/01/18

PRICES SUBJECT TO CHANGE WITHOUT NOTICE